

**Carpenters bench model 3**

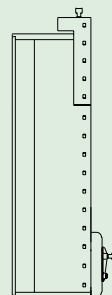

**Carpenters bench model 3**



**ULMIA carpenters bench model 3**

Top and trestle made of selected solid red beech, 45 mm wide cross bars on the face sides, 155 mm wide storage recess, surface waxed and polished. Front vice made of a solid cast iron and steel construction, tail vice with aluminium box guide. Delivery includes 2 tommy bars and 2 rectangular bench dogs.



Products are flat packed in stable collapsible cardboard boxes complete with assembly instructions.

Bench top lengths mm		2000
Order number	3-200	
EAN-CODE 40 44637	10110 1	
<b>Specifications</b>		
Top dimensions without vices W x T mm	2000 x 640	
Worktop thickness mm	50	
Height of bench dog rail	120	
Top dimensions incl. vices W x T mm	2220 x 850	
Working height mm	900	
Clamping width front vice mm	145	
Clamping width tail vice mm	240	
Weight appr. kg	109	

Available accessories are detailed on page 7 and 8